

THE CITY OF NAPOLEON

BUILDING & ZONING DEPARTMENT

255 W. RIVERVIEW

(419)592-4010

Plumbing Permit

Permit Number: PL2007-9

Page 1 of 1

Printed: 3/8/2007

ADDRESS:

1026 Highland Ave.

Applicant

Name: M L Allen

Address: 1026 Highland Ave

Approval Date: 3/8/2007

419-592-6821

Owners

Name: M L Allen

Address: 1026 Highland Ave

Napoleon, OH 43545

Phone: 419-592-6821

Contractors

Fees and Receipts:

Number	Description	Amount
FEE2007-129	Plumbing/outside clean out	\$25.00
Total Fees:		\$25.00
RCPT2007-128		\$25.00
Total Receipts:		\$25.00

repairing outside sewer

APPLICANTS SIGNATURE: Louise Allen

DATE: 3-8-07

REMINDER: YOU MUST CALL (419)592-4010 FOR AN INSPECTION



GLA (A)

CITY OF NAPOLEON GENERAL PERMIT APPLICATION

THIS APPLICATION IS FOR RESIDENTIAL CONSTRUCTION INCLUDING BUILDING, ELECTRICAL, PLUMBING, MECHANICAL, DEMOLITIONS, REMODELING.

DATE: 3-8-07 JOB LOCATION: 1026 Highland Napoleon, OH

OWNER: M.L. Allen PHONE: 419 592-6821

OWNER ADDRESS: 1026 Highland CITY: Napoleon ZIP: 43545

CONTRACTOR: Daniel Allen (son)

PHONE #: _____ CELL PHONE# (419) 206-6211

CONTRACTOR LICENSED WITH THE CITY OF NAPOLEON?: YES NO:

Is any of the above job going to be subcontracted out? Yes No:

If yes to whom: _____

DESCRIPTION OF WORK TO BE

PERFORMED: sewer repairs

ESTIMATED COMPLETION DATE: 4-1-07?

PLEASE MARK THE TYPE OF WORK YOU WILL BE PERFORMING

- | | |
|---|---|
| <input type="checkbox"/> A/C ADD ON | <input type="checkbox"/> REMODELING |
| <input type="checkbox"/> BOILER REPLACEMENT | <input type="checkbox"/> ROOFING |
| <input type="checkbox"/> CURBING | <input checked="" type="checkbox"/> SEWER REPAIRS** |
| <input type="checkbox"/> DECKS * | <input type="checkbox"/> SIDEWALK* |
| <input type="checkbox"/> DRIVEWAY* | <input type="checkbox"/> SIDING |
| <input type="checkbox"/> ELECTRICAL SERVICE UPGRADE | <input type="checkbox"/> STORAGE SHED* |
| <input type="checkbox"/> ELECTRICAL SERVICE NEW | <input type="checkbox"/> SWIMMING POOL* |
| <input type="checkbox"/> FENCE* | <input type="checkbox"/> FURNACE REPLACEMENT |
| <input type="checkbox"/> ADDITIONS* | <input type="checkbox"/> TEMP ELECTRIC |
| <input type="checkbox"/> FURNACE NEW | <input type="checkbox"/> WATER TAP (size _____") |
| <input type="checkbox"/> LAWN METER | <input type="checkbox"/> WINDOWS |
| <input type="checkbox"/> PLUMBING | <input type="checkbox"/> ZONING |

*PLEASE INCLUDE A PICTURE SHOWING MEASUREMENTS FROM EXISTING STRUCTURES AND PROPERTY LINES. INDICATING THE TYPE OF WORK YOU WISH TO PERFORM.

** IF WORK REQUIRES GOING INTO THE STREET A STREET BOND IS REQUIRED!

FOR PERMIT COSTS PLEASE FILL OUT REVERSE SIDE.

PERMIT COST WORKSHEET

JOB	BASE FEE	TOTAL
SIDING (only) TOTAL SQ _____ X 1.00 +	\$5.00 =	\$ _____
ROOFING (only) TOTAL SQ _____ X 1.00 +	\$5.00 =	\$ _____
WINDOWS / DOORS(only) # ____ X 1.00 +	\$5.00 =	\$ _____
ELECTRICAL # OF CIRCUITS _____ X 3.00 +	\$15.00 =	\$ _____
ELECTRICAL SERVICE UPGRADE	\$15.00 =	\$ _____
PLUMBING (INSIDE) replacing/ repairs	\$10.00 =	\$ _____
* SEWER (OUTSIDE)	\$25.00 =	\$ <u>25.00</u>
WATER HEATER	\$5.00	\$ _____
SHED UNDER 200 SQ FT (over 200 see chart)	\$ 5.00	\$ _____
FURNACE OR A/C (REPLACEMNT)	\$ 5.00	\$ _____
DEMOLITION (only)	\$30.00	\$ _____
SIDEWALK REPLACEMENT/ NEW	\$25.00	\$ _____
DRIVEWAY	\$25.00	\$ _____

ALL CONSTRUCTION, ALTERATIONS, REMODELING, SHEDS, DECKS & FENCES NOT LISTED ABOVE IS BASED ON COST OF WORK BEING PERFORMED.

COST OF WORK \$ _____ (SEE CHART) \$ _____

0.00	-	250.00	0.00	11,000.00	-	11,999.00	25.00
250.00	-	1,000.00	10.00	12,000.00	-	12,999.00	26.00
1,000.00	-	1,999.00	12.00	13,000.00	-	13,999.00	27.00
2,000.00	-	2,999.00	14.00	14,000.00	-	14,999.00	28.00
3,000.00	-	3,999.00	16.00	15,000.00	-	15,999.00	29.00
4,000.00	-	4,999.00	18.00	16,000.00	-	16,999.00	30.00
5,000.00	-	5,999.00	19.00	17,000.00	-	17,999.00	31.00
6,000.00	-	6,999.00	20.00	18,000.00	-	18,999.00	32.00
7,000.00	-	7,999.00	21.00	19,000.00	-	19,999.00	33.00
8,000.00	-	8,999.00	22.00	20,000.00	-	20,999.00	34.00
9,000.00	-	9,999.00	23.00	21,000.00	-	21,999.00	35.00
10,000.00	-	10,999.00	24.00	22,000.00	-	22,999.00	36.00
				Over 22,999		Please Call	

*OTHER FEES NOT LISTED MAY APPLY

Date Installed: 3-26-07
 Installed by: Home Owner → M.L. Allen
 Inspected by: Rex Moll

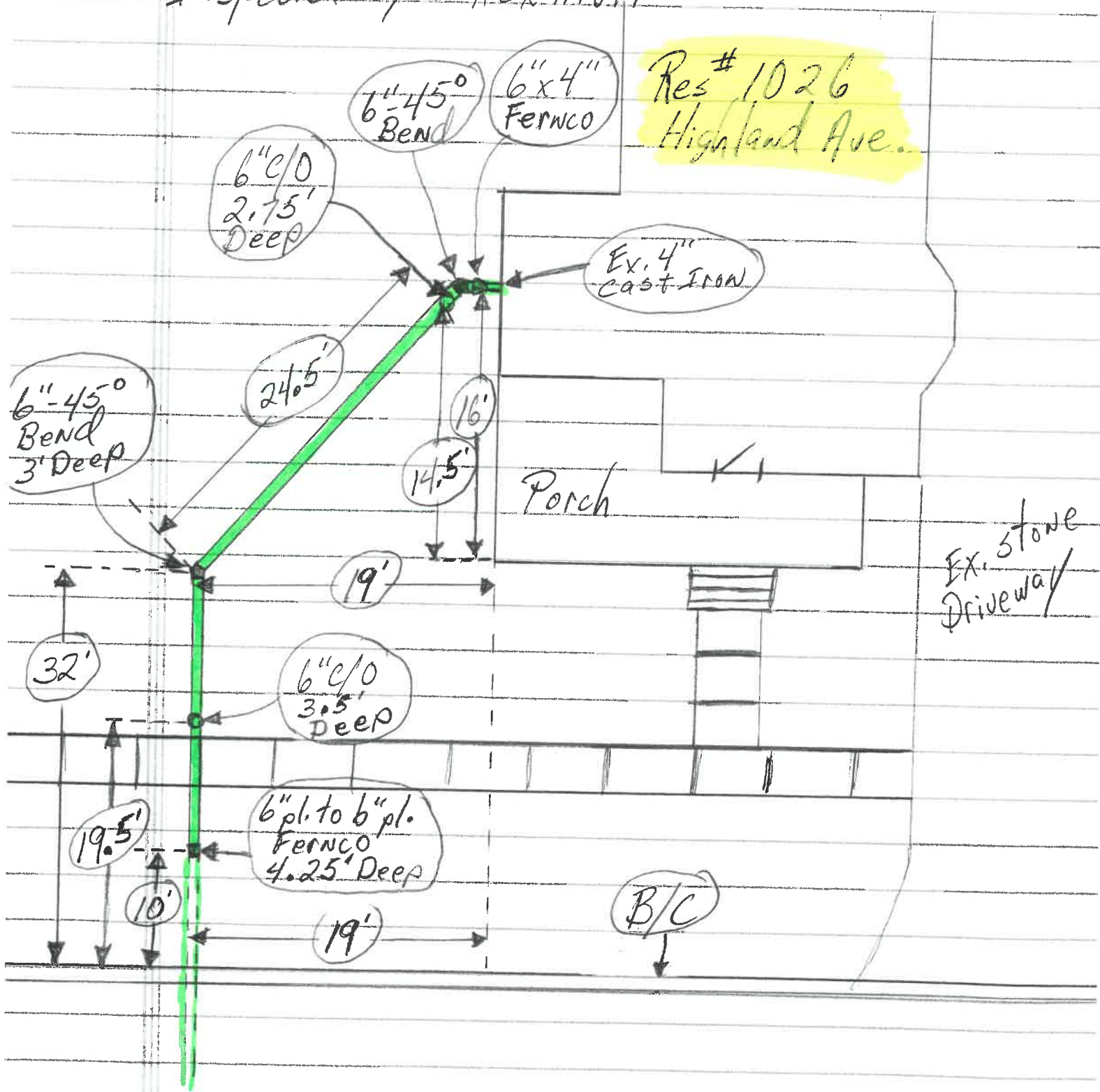

Date Installed: 3-26-07
Installed by: Home Owner → M.L. Allen
Inspected by: Rex Moll

